

## TCH-B100 HAND-HELD PROGRAMMER



### STANDARD FEATURES

- Compact unit
- Easy to use
- Provides address setting and reading
- Can be used on both sensors and modules
- Has the diagnostic ability to display the analog value
- Over 8000 address settings from one battery.

### SPECIFICATIONS

Rated Voltage:	9 VDC
Battery:	9 VDC
Weight:	0.34 lbs
Length:	6 1/4"
Color:	White

### APPLICATION

TCH-B100 is designed for use with all analog sensors and modules.

### ADDRESS SETTING:

1. Install sensor onto programmer, ensuring that sensor protrusions align with programmer grooves.
2. Press the left gray button to switch programmer on. A battery check message will appear followed by the device's address (Unprogrammed sensors will read address 127).
3. Set the required address by incrementing the left and right gray buttons (the display will show three red flashing dots if the address being programmed is different from the device's current address).
4. When the desired address is present, press the red button to store that address. The three red dots on the display will no longer be present.

### PRODUCT PARTS

- 9 Volt Battery
- Remote Programming Cables

Continued on back

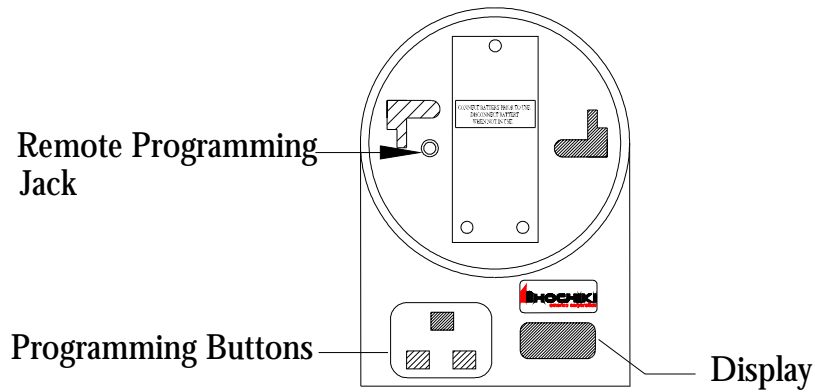

## PROGRAMMING BUTTONS:

LEFT GRAY BUTTON	Power on. Automatically reads the address of a sensor. Subsequent operations will advance the device address by ten.
RIGHT GRAY BUTTON	Power off. Advances the device address by one.
RED BUTTON	Stores the displayed address to the device and is used to read sensor analog levels.

*NOTE: Prior to programming, ensure battery is connected.*

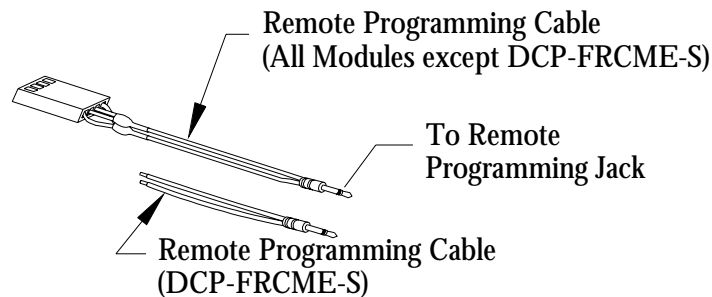

## TESTING A SENSOR

Note: Ionization sensors require a 30 second stabilization period before analog value reading should be taken.

1. Install the sensor and power up programmer as previously described on page 1
2. Press the "Red" button. An "A" will appear on the display followed by the analog value. The value will be continuously updated for three minutes
3. The "ALG" photoelectric sensor should have a value displayed of between 56-63. The "AIE" ionization sensor should have a value displayed of between 52-73.

Values out of these ranges indicate that the sensor chamber has become contaminated. Refer to technical bulletin "HA-96" for proper servicing instructions or return sensor to factory for servicing.

## DISPLAY MESSAGES:

- bAt- On upon power up (battery check). Also on when battery is low. Low battery good for up to 3,000 address setting operation.
- E0 - Attempting to set an address beyond 127.
- E1 - Attempting to program an address with no device connected.
- E2 - Can not find device after power up.
- E3 - Invalid sensor response.
- E4 - Can not find the device program.
- E5 - Device read error.
- E6 - Fail during Analog value reading